

8 N-7

D.D.A.

AREA PLANNING - III

TOTAL AREA OF PLOTS = 800 SQ.YDS.
 NO. OF PLOTS = 8 NOS.
 AREA OF PLOT = 100 SQ.YDS.

PROPOSAL FOR RELOCATION OF 8 PLOTS HAS BEEN APPROVED IN 213th SCREENING COMMITTEE HELD ON 22.01.2001 VIDE ITEM NO. 5:2001 IN FILE NO. ARCH(CO-ORDN.) HUPW/DDA/2001/09

PLAN HAS BEEN AUTHENTICATED BY COMMR.(PLG.) AND CA (HUPW) VIDE ORDER IN FILE F3(29)2001/MP AT PAGE 11/N DATED 24.4.2001

REF. FILE NO.:- F20(115)84/L5B(I)

PROPOSED WARE HOUSING ALTERNATIVE PLOTS CARVED OUT AT 'Y' BLOCK IN NARAINA FOR PLOT NOS. C-6 TO C-13 AT 'Y'-BLOCK

LAY OUT PLAN

SCALE 1:300	DATE	DRG. NO.
PLG. D/MAN	PLG. ASSTT.	ASSTT. DIR.
JT. DIRECTOR	DIRECTOR (AP II)	O.S.D. (A.P.)

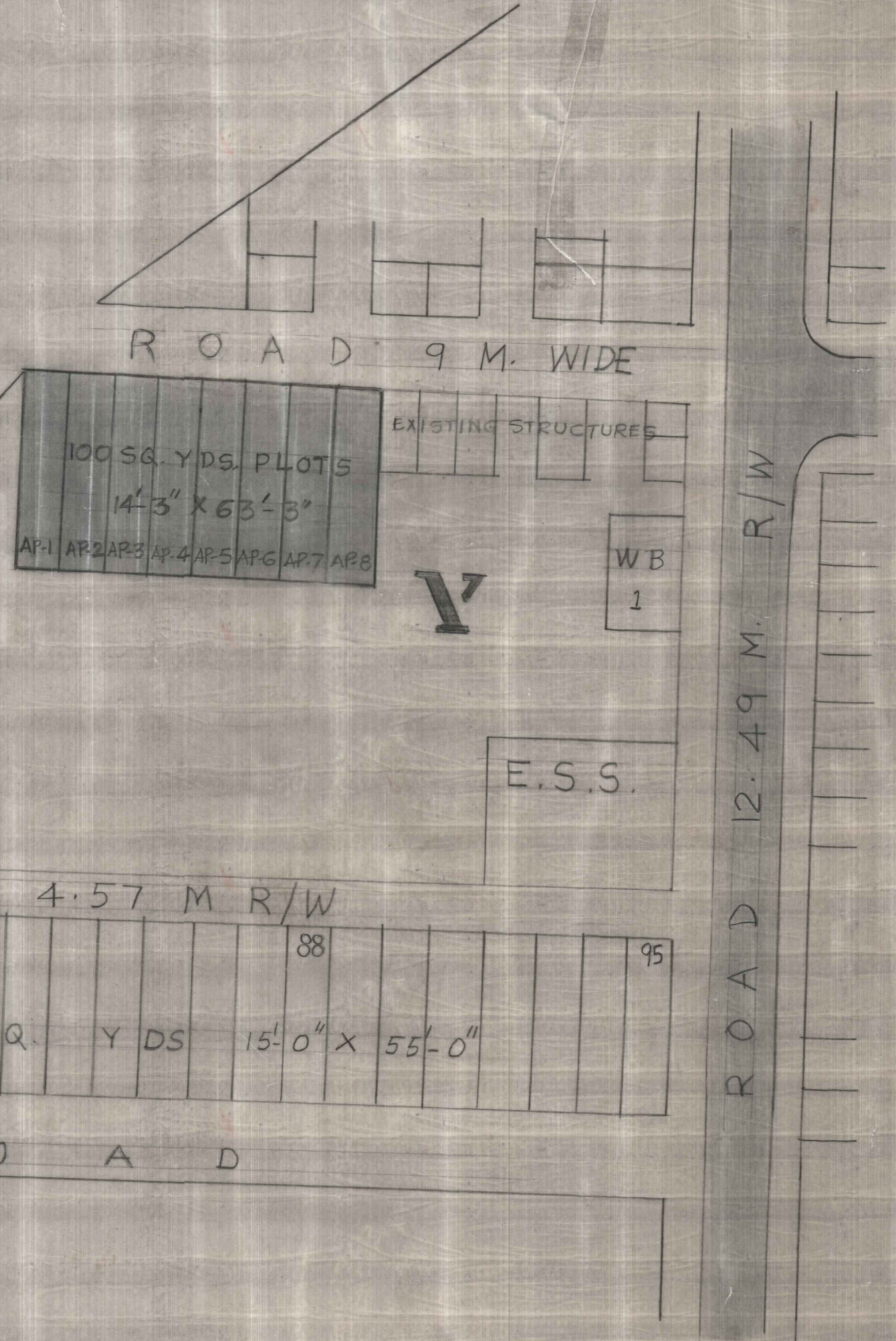
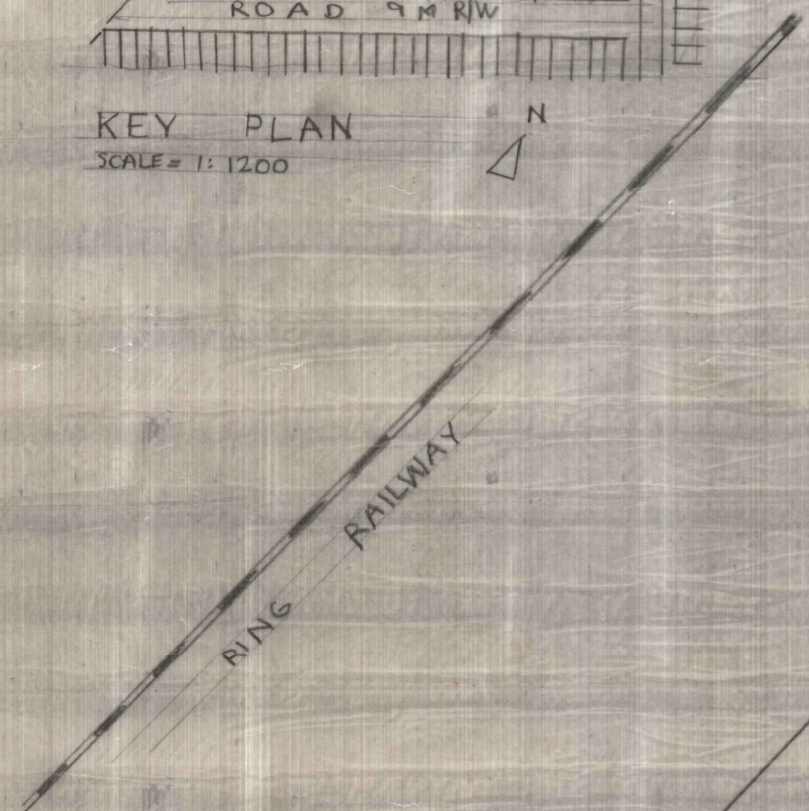
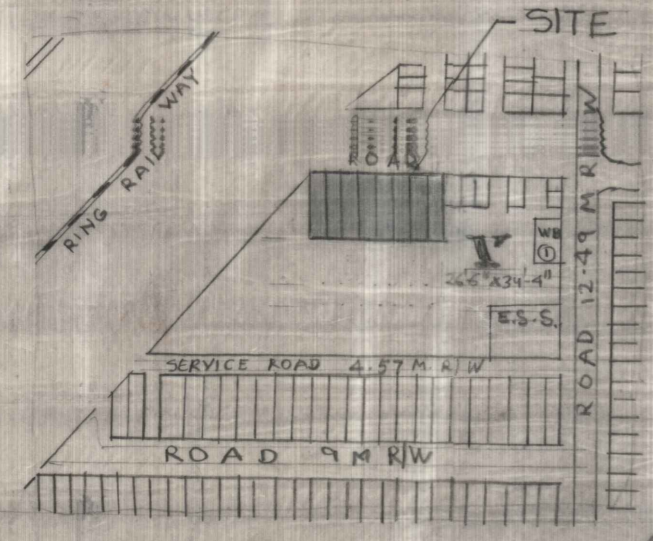

SERVICE ROAD 4.57 M R/W

ROAD	4	75			80					88					95
	3														
	2														
	1			92	S Q.	Y DS	15'-0"	X	55'-0"						

R O A D